

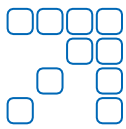

METZ™ Shims - The Alignment Time and Money Saver!

Precut shims pay off through faster, safer, more accurate alignment work.

METZ™ PRECUT SHIMS are made of stainless steel full hard material protected against rust and deformation. Different shim sizes fit motors and generators up to approx 1,000 HP. All shims are laser marked with thickness and size to facilitate identification and re-use. Shims come in a durable light-weight air-tight storage carrying case with proper size divider kits. Each size is available in individual packages for convenience transport. Seven most common use shim thicknesses allow all possible shim change combination with a max. of 3 shims. Burr-free for higher accuracy and safety in precision machinery alignment work.



Advantage of high-quality Pre-cut stainless steel shim to other materials:

- No compress and deformation.
- Reusable.
- Strong and highly corrosion resistant.
- Precut shims sizes conform strictly to all machine frame and Horsepower.

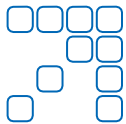

Benefits of METZ™ Alignment Pre-cut Shims

- Save time and money by eliminating costly and time consuming hand cutting and deburring.
- Four times cost effective than traditional hand cut shims to enhance productivity.
- Safety - Reduce hand injuries due to burrs and "snap cuts".
- Save space and easy inventory by eliminating the need to carry a large selection of roll stock.
- Reusable with durable corrosion resistant stainless steel material and no materials waste from hand cut roll.
- Achieve precise alignment with correct size, thickness and no burrs on shims edge.
- Laser marked sizes and clearly marked divider ease house keep and readily with right size shims on hand at the right time.
- Available in four sizes configuration to meet machine alignment needs by eliminate redundancy.
- New durable, lightweight, robust ABS container for easy transport and no-rusty storage.
- Available in convenience pack of 10pcs/20pcs for replenishment.



*Shim thickness from 4 to 6mm and SS316 material available upon request.



METZ shims cases of different individual sizes

METZ water-proof shims suitcase of 450pcs, L300-ABCP

| THICKNESS | THICKNESS | TOLERANCE | TOLERANCE |
|-----------|-----------|-----------|-----------|
| | METRIC | METRIC | |
| Inch | mm | Inch | mm |
| 0.002 | 0.050 | ±.0001 | ±.00254 |
| 0.004 | 0.100 | ±.0002 | ±.00508 |
| 0.008 | 0.200 | ±.0005 | ±.0127 |
| 0.016 | 0.400 | ±.00075 | ±.01905 |
| 0.019 | 0.500 | ±.0008 | ±.0215 |
| 0.025 | 0.700 | ±.0015 | ±.0381 |
| 0.040 | 1.000 | ±.002 | ±.0508 |
| 0.079 | 2.000 | ±.0025 | ±.0635 |
| 0.118 | 3.000 | ±.0025 | ±.0635 |

Each package sizes A, B, C and D case contains 150 pieces high quality stainless steel shim made to meet alignment industrial standard requirement.

* Specifications subject to change without notice.

For detailed information and price, please contact your local distributor or visit our web site:



Precut shims pay off through faster, safer, more accurate alignment work.



Case contains a total of 180pcs Package, Part No.: L100-APN9
(L100-A8 optional thickness)

| Type & Part No. | DIM A x B (mm) | Slot Size (mm) | Thickness (mm) & (Inch) | Box Qty (Pcs) |
|-----------------|----------------|----------------|-------------------------|---------------|
| L100-A1 | 50 x 50 | 16 | 0.05 mm / ~0.002" | 20 |
| L100-A2 | 50 x 50 | 16 | 0.1 mm / ~0.004" | 20 |
| L100-A3 | 50 x 50 | 16 | 0.2 mm / ~0.008" | 20 |
| L100-A3.5 | 50 x 50 | 16 | 0.3 mm / ~0.012" | 20 |
| L100-A4 | 50 x 50 | 16 | 0.4 mm / ~0.016" | 20 |
| L100-A4.5 | 50 x 50 | 16 | 0.5 mm / ~0.019" | 20 |
| L100-A5 | 50 x 50 | 16 | 0.7 mm / ~0.028" | 20 |
| L100-A6 | 50 x 50 | 16 | 1.0 mm / ~0.040" | 20 |
| L100-A7 | 50 x 50 | 16 | 2.0 mm / ~0.079" | 20 |
| L100-A8 * | 50 x 50 | 16 | 3.0 mm / ~0.120" | 10 |

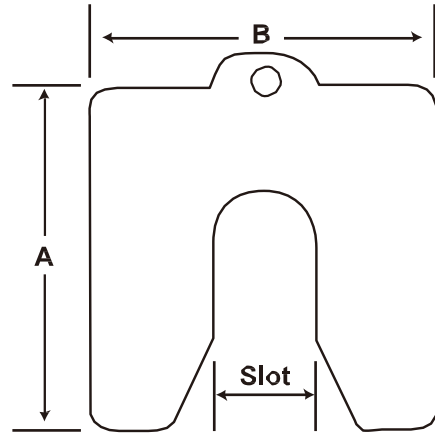

Case contains a total of 180pcs Package, Part No.: L100-BPN9
(L100-B8 optional thickness)

| Type & Part No. | DIM A x B (mm) | Slot Size (mm) | Thickness (mm) & (Inch) | Box Qty (Pcs) |
|-----------------|----------------|----------------|-------------------------|---------------|
| L100-B1 | 75 x 75 | 22 | 0.05 mm / ~0.002" | 20 |
| L100-B2 | 75 x 75 | 22 | 0.1 mm / ~0.004" | 20 |
| L100-B3 | 75 x 75 | 22 | 0.2 mm / ~0.008" | 20 |
| L100-B3.5 | 75 x 75 | 22 | 0.3 mm / ~0.012" | 20 |
| L100-B4 | 75 x 75 | 22 | 0.4 mm / ~0.016" | 20 |
| L100-B4.5 | 75 x 75 | 22 | 0.5 mm / ~0.019" | 20 |
| L100-B5 | 75 x 75 | 22 | 0.7 mm / ~0.028" | 20 |
| L100-B6 | 75 x 75 | 22 | 1.0 mm / ~0.040" | 20 |
| L100-B7 | 75 x 75 | 22 | 2.0 mm / ~0.079" | 20 |
| L100-B8 * | 75 x 75 | 22 | 3.0 mm / ~0.120" | 10 |

All dimensions in mm & inch. Thickness tolerances as above standard chart shown. Materials: 304 Stainless Steel. Available in 4 different machine foot sizes in 8 different thickness.



Case contains a total of 180pcs Package, Part No.: L100-CPN9
(L100-C8 optional thickness)

| Type & Part No. | DIM A x B (mm) | Slot Size (mm) | Thickness (mm) & (Inch) | Box Qty (Pcs) |
|-----------------|----------------|----------------|-------------------------|---------------|
| L100-C1 | 100 x 100 | 32 | 0.05 mm / ~0.002" | 20 |
| L100-C2 | 100 x 100 | 32 | 0.1 mm / ~0.004" | 20 |
| L100-C3 | 100 x 100 | 32 | 0.2 mm / ~0.008" | 20 |
| L100-C3.5 | 100 x 100 | 32 | 0.3 mm / ~0.012" | 20 |
| L100-C4 | 100 x 100 | 32 | 0.4 mm / ~0.016" | 20 |
| L100-C4.5 | 100 x 100 | 32 | 0.5 mm / ~0.019" | 20 |
| L100-C5 | 100 x 100 | 32 | 0.7 mm / ~0.028" | 20 |
| L100-C6 | 100 x 100 | 32 | 1.0 mm / ~0.040" | 20 |
| L100-C7 | 100 x 100 | 32 | 2.0 mm / ~0.079" | 20 |
| L100-C8 * | 100 x 100 | 32 | 3.0 mm / ~0.120" | 10 |

*Shim thickness from 4 to 6mm and SS316 material available upon request.

Case contains a total of 160pcs Package, Part No.: L100-DPN8
(L100-D8 optional thickness)

| Type & Part No. | DIM Ax B (mm) | Slot Size (mm) | Thickness (mm) & (Inch) | Box Qty (Pcs) |
|-----------------|---------------|----------------|-------------------------|---------------|
| L100-D1 | 125 X 125 | 44 | 0.05 mm / ~0.002" | 20 |
| L100-D2 | 125 X 125 | 44 | 0.1 mm / ~0.004" | 20 |
| L100-D3 | 125 X 125 | 44 | 0.2 mm / ~0.008" | 20 |
| L100-D4 | 125 X 125 | 44 | 0.4 mm / ~0.016" | 20 |
| L100-D4.5 | 125 X 125 | 44 | 0.5 mm / ~0.019" | 20 |
| L100-D5 | 125 X 125 | 44 | 0.7 mm / ~0.028" | 20 |
| L100-D6 | 125 X 125 | 44 | 1.0 mm / ~0.040" | 20 |
| L100-D7 | 125 X 125 | 44 | 2.0 mm / ~0.079" | 20 |
| L100-D8 * | 125 X 125 | 44 | 3.0 mm / ~0.120" | 10 |

- ① Easily and quickly identified by permanent laser markings indicating shim thickness & sizes.
- ② Manufactured from high quality stainless steel to prevent corrosion.
- ③ Burr-free and specially rounded corners help avoid injury to maintenance personnel during the alignment work.
- ④ Extraction and insertion tab facilitates positioning and removal of the shim.
- ⑤ Pre-cut shims are completely flat to ensures stability and consistent machine support over the full surface of the shim.

*Specifications subject to change without notice.

Distributor:

www.metzin.com
METZIN Technologies & Consulting Pte Ltd
 No.7, Tech Park Crescent, Singapore 638125
 Tel: +65 9738 8913 / 9231 1786 / 6898 2957
 Fax: +65 6259 0892
 Email: info@metzin.com Website: www.metzin.com

For detailed information and price, please contact your local distributor or visit our web site:

www.metzin.com